



#### GENERAL FEATURES

- Spring-return (self-return)
- 60°, 110° or 120° electrical angle
- 120° or 150° limited mechanical angle
- M6x1 threaded shaft (optional others)
- 30 mm body diameter
- Potentiometric output
- ±%1 linearity
- 2 million cycles lifetime
- IP67 protection

#### APPLICATION FIELDS

- Textile machinery
- Automatic door control systems
- Automotive
- All kinds of control and measurement applications

#### TECHNICAL FEATURES

<b>Electrical Angle</b>	60°, 110° or 120°
<b>Mechanical Angle</b>	120° or 150°
<b>Independent Linearity</b>	±%1
<b>Repeatability</b>	0.1° max.
<b>Output Type</b>	Resistive
<b>Supply Voltage</b>	42V max.
<b>Resistance Values</b>	2K, 5K, 10K
<b>Resistance Tolerance</b>	±%20
<b>Resistance Element</b>	Conductive Plastic
<b>Insulating Resistance</b>	DC500V 1GΩ min.
<b>Resolution</b>	Infinite
<b>Recommended Wiper Current</b>	100 μA max.
<b>Electrical Connection</b>	3x0,5 mm <sup>2</sup> NYAF cable (standard 150mm, optional others)
<b>Rotation Torque</b>	$4.9 \times 10^{-2} \pm 1.96 \times 10^{-2} \sim 8.33 \times 10^{-2} \pm 1.96 \times 10^{-2}$ Nm (0.5±0.2~0.85±0.2kgf-cm)
<b>Life</b>	2 million cycles
<b>Operating Temperature</b>	-40°C ... +100°C
<b>Storage Temperature</b>	-40°C ... +100°C
<b>Body Material</b>	Delrin (POM)
<b>Shaft Material</b>	AISI303
<b>Protection Class</b>	IP67

## ELECTRICAL CONNECTIONS

SIGNAL	CABLE COLOR
+V	Brown (1)
Output Signal	Yellow (2)
-V	Black (3)

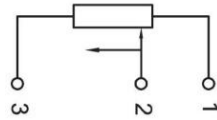

**Potentiometer connection  
(voltage divider)**

## MECHANICAL DIMENSIONS (in mm)

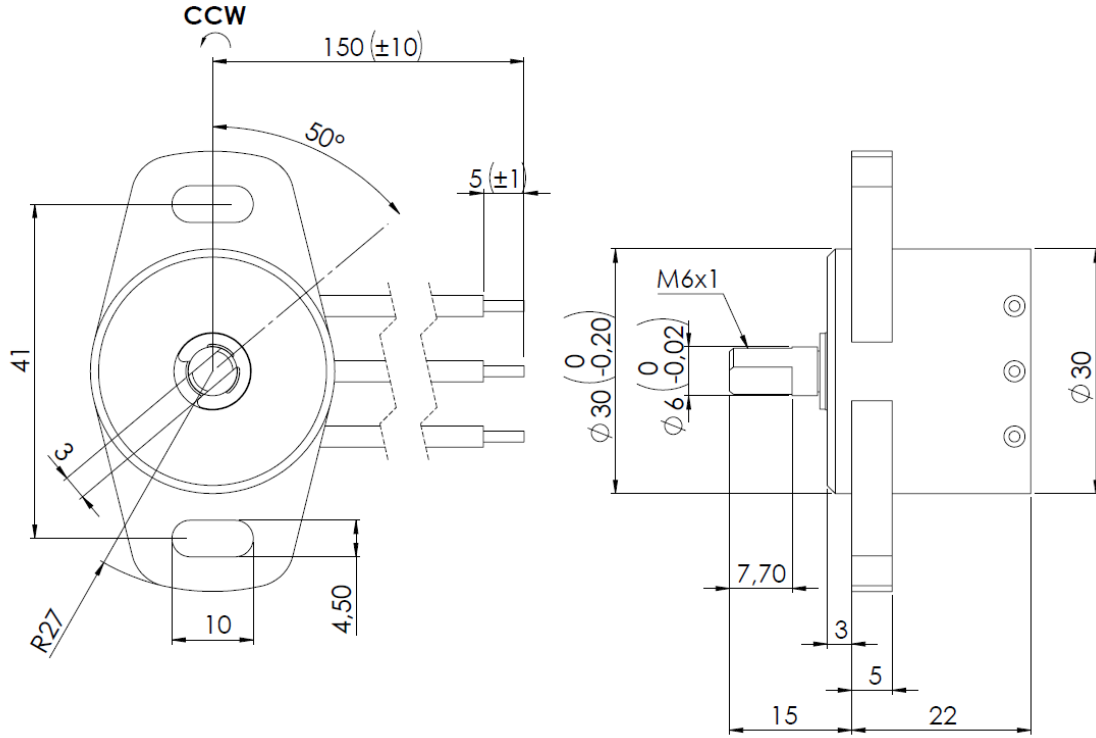

## ORDER CODE

Model		Electrical Angle		Resistance Value		Shaft Diameter					
60	: 60°	2K	: 2K	M6x1	: M6x1 threaded (standard)						
110	: 110°	5K	: 5K		: *Optional others						
120	: 120°	10K	: 10K								
<b>SRP</b>	-	<b>XXX</b>	-	<b>XXX</b>	-	<b>XX</b>	-	<b>XXX</b>	-	<b>XXX</b>	
<b>Body Diameter</b>				<b>Mechanical Angle</b>				<b>Cable Length</b>			
030: 30mm				120 : 120° 150 : 150°				0.15M: 150mm (standard) *Optional others			